

FRAMELESS GLASS CURTAINS LIMITED TEST REPORT

SCOPE OF WORK

AAMA/WDMA/CSA 101/I.S.2/A440 TESTING ON P5, SLIDING/STACKING DOOR (3L/3R)

REPORT NUMBER

S2754.03-301-44-R0

TEST DATE(S)

10/29/25 - 02/24/26

ISSUE DATE

03/04/26

PAGES

24

DOCUMENT CONTROL NUMBER

RT-R-AMER-Test-2804 (06/21/24)

© 2017 INTERTEK

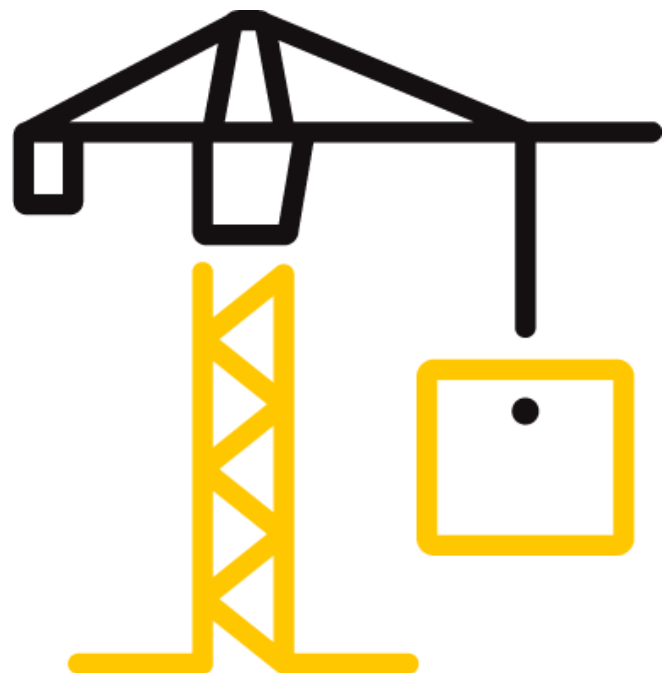

TEST REPORT FOR FRAMELESS GLASS CURTAINS LIMITED

Report No.: S2754.03-301-44-R0

Date: 03/04/26

REPORT ISSUED TO

FRAMELESS GLASS CURTAINS LIMITED

Ballard Business Park, Cuxton Road

Unit 6

Strood, Kent ME2 2NY

SECTION 1

SCOPE

Architectural Testing, Inc. (an Intertek company) dba Intertek Building & Construction (B&C) was contracted by Frameless Glass Curtains Limited, Strood, Kent to perform testing in accordance with AAMA/WDMA/CSA 101/I.S.2/A440 on their P5, Sliding/Stacking Door (3L/3R). Results obtained are tested values and were secured by using the designated test method(s). Testing was conducted at the Intertek test facility in Fresno, California where testing was completed.

This report does not constitute certification of this product nor an opinion or endorsement by this laboratory. Intertek B&C will service this report for the entire test record retention period. The test record retention period ends five years after the test date. Test records, such as detailed drawings, datasheets, representative samples of test specimens, or other pertinent project documentation, will be retained for the entire test record retention period.

Unless differently required, Intertek reports apply the "Simple Acceptance" rule, also called "Shared Risk approach," of ILAC-G8:09/2019, Guidelines on Decision Rules and Statements of Conformity.

For INTERTEK B&C:

COMPLETED BY:	Jarod Hardman	REVIEWED BY:	Tyler Westerling, P.E.
TITLE:	Senior Project Lead	TITLE:	Regional Manager
SIGNATURE:		SIGNATURE:	
DATE:	03/04/26	DATE:	03/04/26

JSH:ms

This report is for the exclusive use of Intertek's Client and is provided pursuant to the agreement between Intertek and its Client. Intertek's responsibility and liability are limited to the terms and conditions of the agreement. Intertek assumes no liability to any party, other than to the Client in accordance with the agreement, for any loss, expense or damage occasioned by the use of this report. Only the Client is authorized to permit copying or distribution of this report and then only in its entirety. Any use of the Intertek name or one of its marks for the sale or advertisement of the tested material, product or service must first be approved in writing by Intertek. The observations and test results in this report are relevant only to the sample(s) tested. This report by itself does not imply that the material, product, or service is or has ever been under an Intertek certification program.

TEST REPORT FOR FRAMELESS GLASS CURTAINS LIMITED

Report No.: S2754.03-301-44-R0

Date: 03/04/26

SECTION 2

SUMMARY OF TEST RESULTS

TITLE	RESULTS
AAMA/WDMA/CSA 101/I.S.2/A440-22	Class LC – DP25: Size Tested 6150 x 2100 mm (242-1/8 x 82-43/64 In.) – Type FLD
Design Pressure	±1440 Pa (±30.08 psf)
Air Infiltration	<0.1 L/s/m ² (<0.01 cfm/ft ²)
Water Penetration Resistance Test Pressure	180 Pa (3.76 psf)

SECTION 3

TEST SPECIFICATION(S)/METHOD(S)

The specimens were evaluated in accordance with the following:

AAMA/WDMA/CSA 101/I.S.2/A440:22, *North American Fenestration Standard/Specification for Windows, Doors, and Skylights*

The following test methods were used during testing:

ASTM E283/E283M-19, *Standard Test Method for Determining Rate of Air Leakage Through Exterior Windows, Skylights, Curtain Walls, and Doors Under Specified Pressure Differences Across the Specimen*

ASTM E330/E330M-14(2021), *Standard Test Method for Structural Performance of Exterior Windows, Doors, Skylights and Curtain Walls by Uniform Static Air Pressure Difference*

ASTM E547-00(2016), *Standard Test Method for Water Penetration of Exterior Windows, Skylights, Doors, and Curtain Walls by Cyclic Static Air Pressure Difference*

ASTM E987-88(2017), *Standard Test Methods for Deglazing Force of Fenestration Products*

ASTM E2068-00(2022), *Standard Test Method for Determination of Operating Force of Sliding Windows and Doors*

AAMA 1304-18, *Voluntary Specification for Determining Forced Entry Resistance of Side-Hinged Door Systems*

TEST REPORT FOR FRAMELESS GLASS CURTAINS LIMITED

Report No.: S2754.03-301-44-R0

Date: 03/04/26

SECTION 4

MATERIAL SOURCE/INSTALLATION

Test specimen was provided by the client. Representative samples of the test specimen(s) will be retained by Intertek B&C for a minimum of five years from the test completion date.

The specimen was installed into a Douglas-Fir wood line steel test chamber. The rough opening allowed for a 3/8" shim space and the exterior perimeter of the specimen was sealed to the test buck. Installation of the tested product was performed by the client.

LOCATION	ANCHOR DESCRIPTION	ANCHOR SPACING
Through frame	#10 x 3" wood screw	29" on center jambs and sill, 20" on center at head

SECTION 5

EQUIPMENT

The following equipment was utilized to apply Forced Entry Resistance (FER) loading in accordance with AAMA 1304:

EQUIPMENT	ASSET NUMBER(S)	CALIBRATION DUE DATE
Load Cell	INT01368	03/19/26

SECTION 6

LIST OF OFFICIAL OBSERVERS

NAME	COMPANY
Matt Cohen	Frameless Glass Curtains Limited
Barry Cohen	Frameless Glass Curtains Limited
Paul Beresford	Frameless Glass Curtains Limited
Neil Blunt	Frameless Glass Curtains Limited
Nicholas Bean	Intertek B&C
Jarod Hardman	Intertek B&C

TEST REPORT FOR FRAMELESS GLASS CURTAINS LIMITED

Report No.: S2754.03-301-44-R0

Date: 03/04/26

SECTION 7

TEST SPECIMEN DESCRIPTION

Product Type: Sliding/Stacking Door (3L/3R)

Series/Model: 5P

Product Size(s):

Test Specimen #1

OVERALL AREA:	WIDTH		HEIGHT	
	Millimeters	Inches	Millimeters	Inches
17.84 m ² (191.97 ft ²)				
Overall size	6150	242-1/8	2100	82-43/64
Panel (x6)	950	37-13/32	1965	77-23/64

Frame Construction:

MEMBER	MATERIAL	DESCRIPTION
Sill	Aluminum	Thermally broken extrusion, Part #SWL9287
Head	Aluminum	Thermally broken extrusion, Part #SWL9285
Jambs	Aluminum	Thermally broken extrusion, Part #SWL7998
Jambs	Aluminum	Locking jamb, thermally broken extrusion, Part #13
	JOINERY TYPE	DETAIL
All corners	Coped	Secured to jamb and sealed.

Panel Construction:

MEMBER	MATERIAL	DESCRIPTION
Rails	Aluminum	Thermally broken extrusion, Part #SWL9286
	JOINERY TYPE	DETAIL
All corners	N/A	N/A

Reinforcement: *No reinforcement was utilized.*

TEST REPORT FOR FRAMELESS GLASS CURTAINS LIMITED

Report No.: S2754.03-301-44-R0

Date: 03/04/26

Weatherstripping:

DESCRIPTION	QUANTITY	LOCATION
Vinyl wrapped foam, Part #1	4 rows	Channel inserted into lock jamb of frame at interior and exterior face.
Polypile with fin, Part #2	4 rows	Channel inserted into head of frame at head.
Polypile with fin, Part #2	2 rows	Channel inserted into bottom rail of each panel.
Hollow bulb gasket, Part #14	2 rows	Channel inserted into bottom rail of each panel.
Polypile with fin, Part #3	2 rows	Channel inserted into lock jamb of frame at interior and exterior face.
Rubber gasket, Part #4	1 row	Adhered to each stile of each panel in opposing directions of intermediate joints.
Rubber gasket, Part #4	2 rows	Adhered to lock jamb of end panel stiles.

Glazing: *No conclusions of any kind regarding the adequacy or inadequacy of the glass in any glazed test specimen(s) can be made.*

GLASS TYPE	SPACER TYPE	INTERIOR LITE	EXTERIOR LITE	GLAZING METHOD
1" IG	GL-S (Stiles) TP-D (Rails)	1/4" tempered	1/4" tempered	Channel glazed into rails with Eurobond Quick Fix flex adhesive.

LOCATION	QUANTITY	DAYLIGHT OPENING		GLASS BITE
		Millimeters	Inches	
Panel	6	950 x 1840	37-13/32 x 72-7/16	1"

TEST REPORT FOR FRAMELESS GLASS CURTAINS LIMITED

Report No.: S2754.03-301-44-R0

Date: 03/04/26

Drainage:

METHOD	SIZE	QUANTITY	LOCATION
Weephole	1/4" diameter	6	Through sill face, 13-1/2"-15" from corner and 28-1/2"-57" on center spacing.

Hardware:

DESCRIPTION	QUANTITY	LOCATION
Locking assembly	2	Secured to jamb of frame at each jamb.
PVC strip	2 rows	Channel inserted into sill frame extrusion.
Slide pivot	2 per panel	Secured to top and bottom rail of panels.
Locating bracket	1 per panel	Secured to bottom rail of panels at opposite side to slide pivot.
Locating T-lug	2 per panel	Secured to top rail of panels at opposite side to slide pivot.

Screen Construction: *No screen was utilized.*

TEST REPORT FOR FRAMELESS GLASS CURTAINS LIMITED

Report No.: S2754.03-301-44-R0

Date: 03/04/26

SECTION 8

TEST RESULTS

The temperature during testing was 13-21°C (55-70°F). The results are tabulated as follows:

Test Specimen #1:

TITLE OF TEST	RESULTS	ALLOWED	NOTE
Operating Force, per ASTM E2068	Initiate Motion: 22.2 N (5.0 lbf) Maintain Motion: 13.3 N (3.0 lbf) Latches: 8.9 N (2.0 lbf)	155 N (35 lbf) max 155 N (35 lbf) max 100 N (22.5 lbf) max	
Air Leakage, Infiltration per ASTM E283 at 75 Pa (1.57 psf)	<0.1 L/s/m ² (<0.01 cfm/ft ²)	1.5 L/s/m ² (0.3 cfm/ft ²) max.	1, 2
Air Leakage, Exfiltration per ASTM E283 at 75 Pa (1.57 psf)	0.1 L/s/m ² (0.01 cfm/ft ²)	1.5 L/s/m ² (0.3 cfm/ft ²) max.	1, 2
Water Penetration, per ASTM E547 at 180 Pa (3.76 psf)	Pass	No leakage	
Uniform Load Deflection, per ASTM E330 Deflections taken at vertical panel joint +1200 Pa (+25.06 psf) -1200 Pa (-25.06 psf)	N/A	N/A	3
Uniform Load Structural, per ASTM E330 Permanent set taken at vertical panel joint +1800 Pa (+37.59 psf) -1800 Pa (-37.59 psf)	N/A	N/A	3
Forced Entry Resistance, per ASTM AAMA 1304	Pass	No entry	

TEST REPORT FOR FRAMELESS GLASS CURTAINS LIMITED

Report No.: S2754.03-301-44-R0

Date: 03/04/26

Test Specimen #1:

TITLE OF TEST	RESULTS	ALLOWED	NOTE
OPTIONAL PERFORMANCE			
Uniform Load Deflection, per ASTM E330 Deflections taken at vertical panel joint +1440 Pa (+30.08 psf) -1440 Pa (-30.08 psf)	3.8 mm (0.15") 4.1 mm (0.16")	Report only	4, 5, 6
Uniform Load Structural, per ASTM E330 Permanent set taken at vertical panel joint +2160 Pa (+45.11 psf) -2160 Pa (-45.11 psf)	0.3 mm (0.01") 1.5 mm (0.06")	7.9 mm (0.31") max. 7.9 mm (0.31") max.	5, 6

Note 1: The tested specimen meets (or exceeds) the performance levels specified in AAMA/WDMA/CSA 101/I.S.2/A440 for air leakage resistance.

Note 2: Test Date 10/29/25 / Time: 9:00 AM

Note 3: The client opted to start at a pressure higher than the minimum required. Test results are reported under Optional Performance.

Note 4: The deflections reported are not limited by AAMA/WDMA/CSA 101/I.S.2/A440 for this product designation. The deflection data is recorded in this report for special code compliance and information only.

Note 5: Loads were held for 10 seconds.

Note 6: Tape and film were used to seal against air leakage during structural testing. In our opinion, the tape and film did not influence the results of the test.

**SECTION 9
ALTERATIONS**

No alterations were required.

TEST REPORT FOR FRAMELESS GLASS CURTAINS LIMITED

Report No.: S2754.03-301-44-R0

Date: 03/04/26

SECTION 10

LOCATION OF AIR SEAL

The air seal between the test specimen and the test wall is detailed below. The seal is made of foam weatherstripping and is attached to the edge of the test specimen buck. The test specimen buck is placed against the test wall and clamped in place, compressing the weatherstripping and creating a seal.

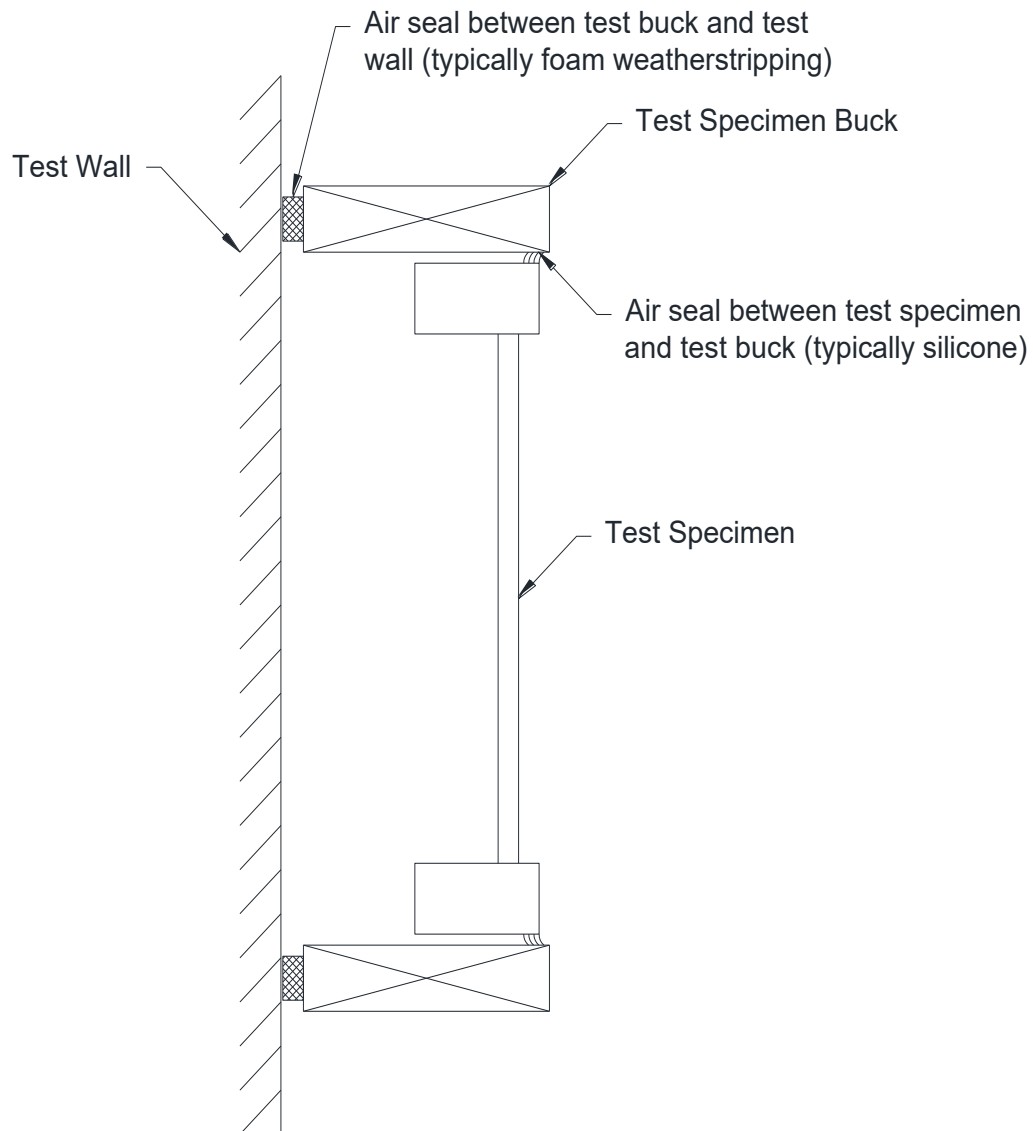



Total Quality. Assured.

2524 E. Jensen Ave
Fresno, California 93706

Telephone: 559-233-8705
Facsimile: 717-764-4129
www.intertek.com/building

TEST REPORT FOR FRAMELESS GLASS CURTAINS LIMITED

Report No.: S2754.03-301-44-R0

Date: 03/04/26

SECTION 11

CONCLUSION

The specimen tested successfully met the performance requirements for a **Class LC – DP25: Size Tested 6150 x 2100 mm (242-1/8 x 82-43/64 in.) – Type FLD** rating.

TEST REPORT FOR FRAMELESS GLASS CURTAINS LIMITED

Report No.: S2754.03-301-44-R0

Date: 03/04/26

SECTION 12 PHOTOGRAPHS



Photo No. 1
Test Specimen Overall



Photo No. 2
Test Specimen during Air Infiltration

TEST REPORT FOR FRAMELESS GLASS CURTAINS LIMITED

Report No.: S2754.03-301-44-R0

Date: 03/04/26



Photo No. 3
Test Specimen during Structural Wind Loading



Total Quality. Assured.

2524 E. Jensen Ave
Fresno, California 93706

Telephone: 559-233-8705
Facsimile: 717-764-4129
www.intertek.com/building

TEST REPORT FOR FRAMELESS GLASS CURTAINS LIMITED

Report No.: S2754.03-301-44-R0

Date: 03/04/26

SECTION 13 DRAWINGS

The test specimen drawings have been reviewed by Intertek B&C and are representative of the test specimen(s) reported herein. Test specimen construction was verified by Intertek B&C per the drawings included in this report. Any deviations are documented herein or on the drawings.

This Drawing is the Property of Frameless Glass Curtains LTD
 Bottom track level threshold is 5mm above finished floor level (FFL)
 To ensure the track is not pinched a 5mm expansion gap must be used on both sides
 All Internal and External Finishes are Completed by Others to Suit Frame Installation by FGC
 Head Detail to be Confirmed Prior to Approval Manufacture
 An 18mm tolerance to opening handle back plate is required please advise on reveal finishes prior to approval of manufacture.
 Drawings show structural dimensions FGC will allow for their own tolerance for the Manufactured Dimensions.

CRITICAL DIMENSIONS

Finished Floor Level (FFL) to Head & wall opening dimensions are critical to manufacture. The critical dimensions must NOT be changed post FGC survey. Any changes to these levels after manufacture will result in re-manufacture of FGC components at the clients expense.

Any Tolerances Shown are for FGC's fitting to allow for dimensional variations in glass panels

NOTE:

DO NOT SCALE FROM DRAWINGS
 All dimensions to be checked on site by the contractor and any discrepancies to be notified to FGC prior to works being commenced.
 © All Rights Reserved. Copyright in all documents and drawings prepared by FGC and in any work executed from those documents and drawings shall remain the property of FGC.

REV:	DESCRIPTION:	DATE:

A	Discriptions amended	07/04/25
---	----------------------	----------

CLIENT:	FGC
---------	-----

TITLE:
 Horizontal & Vertical Sections
 P5 Double Glazed Seal & Fir Locations

SCALE AT A3:	DATE:	CONTRACT NO:
1 : 1	08/01/25	N/A
DRAWING NO:	REVISION:	
UVAL01-SEALS	A	

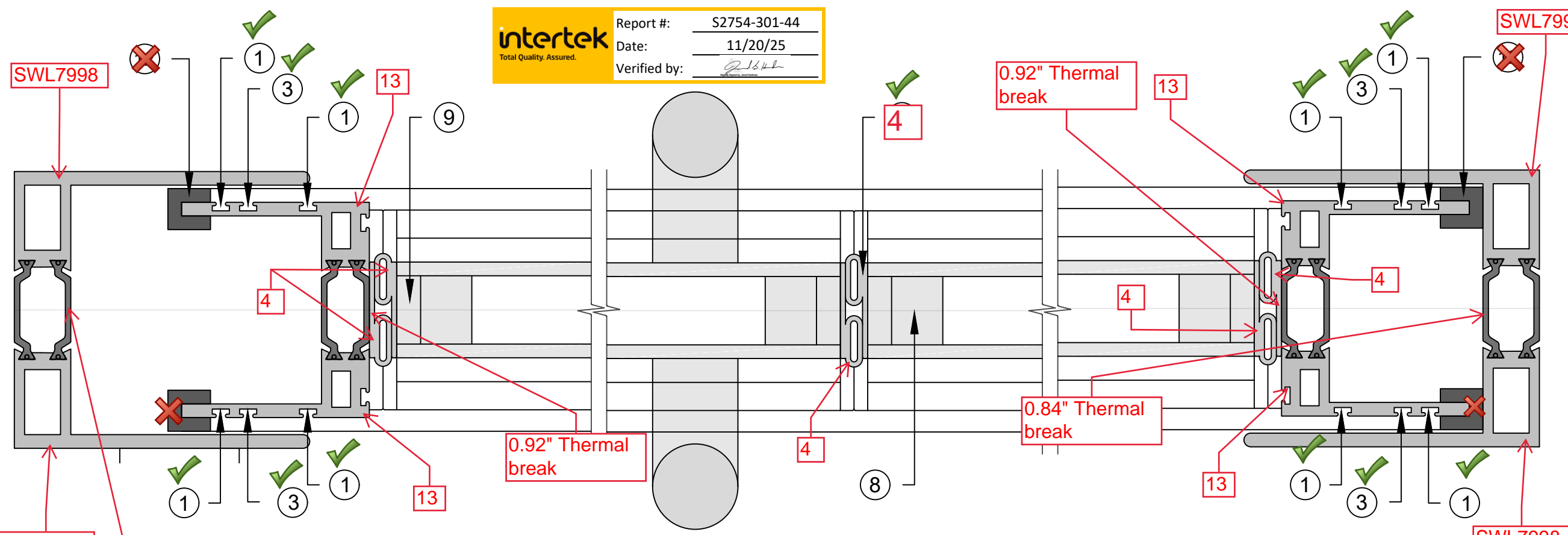

Horizontal Section Column & Top Hat - Staid Side

Horizontal Section Panel Joint

Horizontal Section Column & Top Hat - Compression Side

0.84" Thermal break

- ① Schlegel/Vinyl Wrapped Foam
- ② Fur/Polypile (Large)
- ③ Fur/Polypile (Small)
- ④ Rubber Gasket
- ⑤ White PVC strip
- ⑥ Rubber P Seal
- ⑦ Eurobond Quick Fix 2-Part Flex Adhesive Fast Curing
- ⑧ Glass Spacer Bar
- ⑨ Isomelt R
- ⑩ Wurth Bond & seal Power
- ⑪ Wurth Bond & seal Power

 C-shaped white rubber
 **14** Hollow bulb gasket

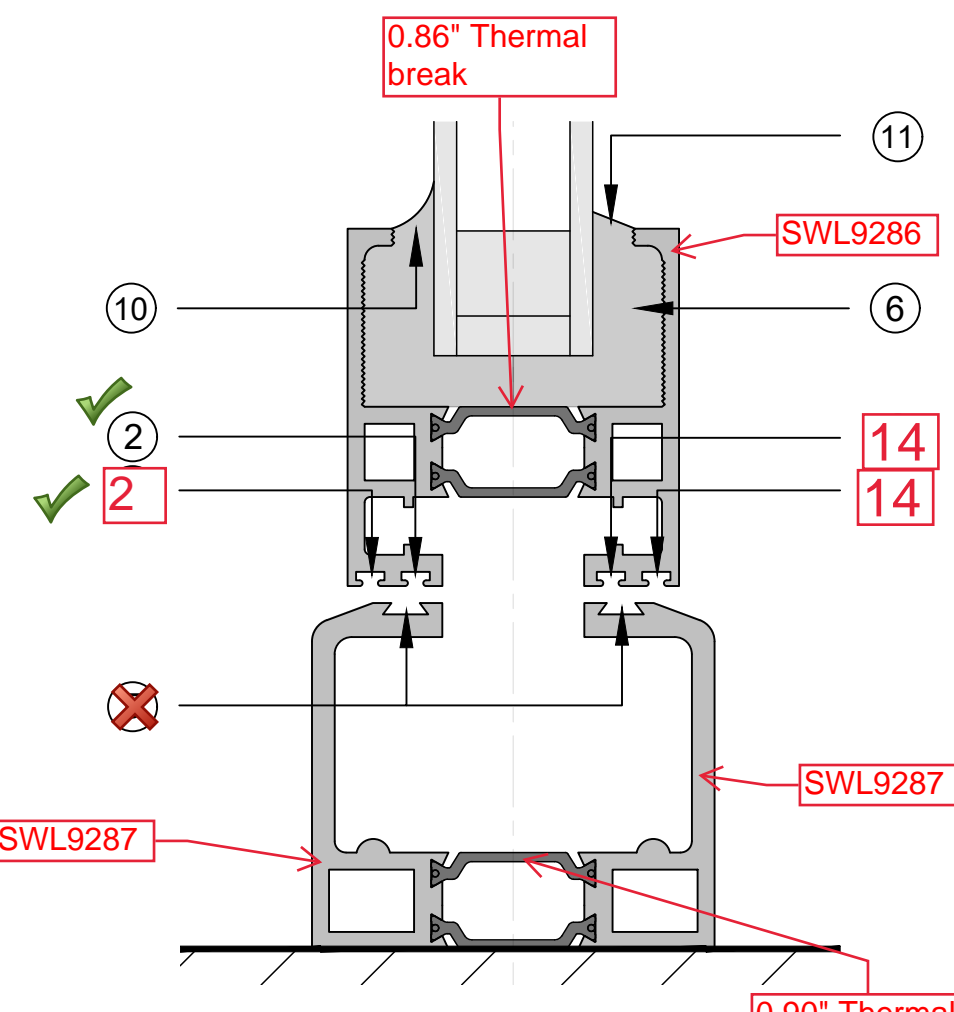

Lower Vertical Section Bottom Track & Panel Profile

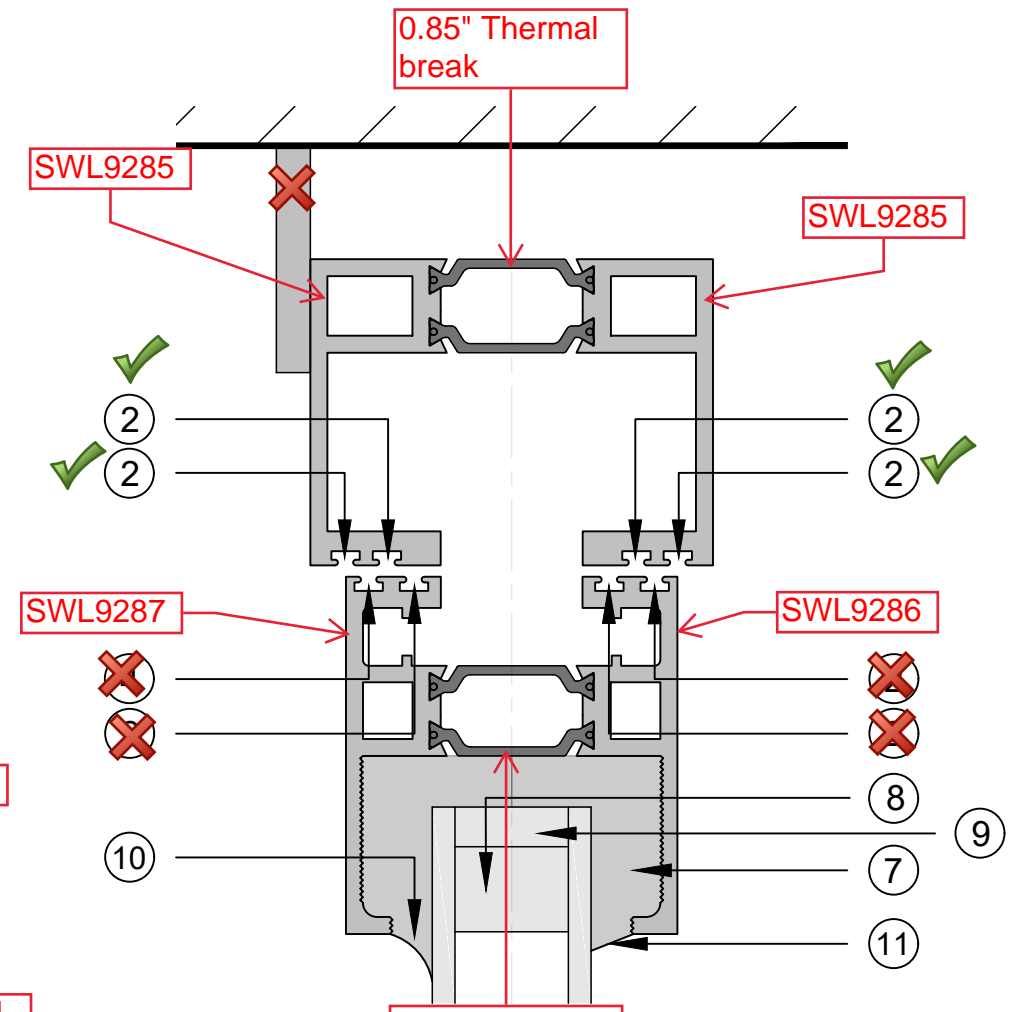

Head Section Top Track & Panel Profile

Scale 1.5:1

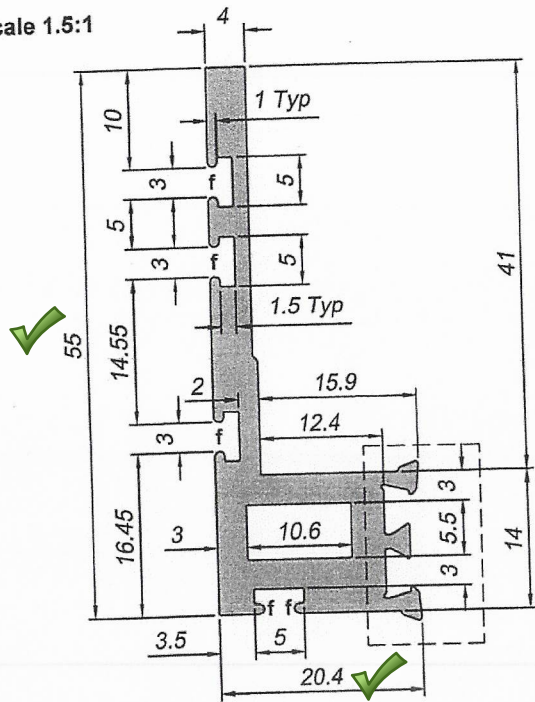

Scale 3:1

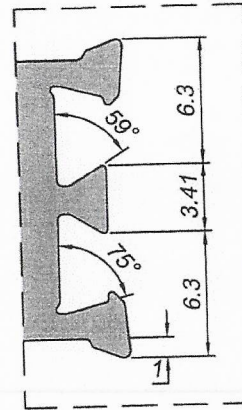

Scale 1:1

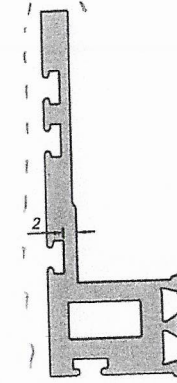

13

VISIBLE

Blweb 23/3/21

Painted Aluminum

Finish:

CLIENT

Service Metals (East Anglia) Ltd

TITLE

Top hat extrusion

V = 0.00mm x 90° Vee Groove
Unspec. Radii to R0.20mm
Unspec. Thickness: 0.00mm

Visible Surface - VS - - - - -

DRAWN	YT
DATE	DECEMBER 2020
SCALE	1:1 SCALE @ A4

RADII

- = 0.20
- = 0.25
- = 0.30
- x = 0.40
- = 0.50
- * = 0.75
- △ = 1.00
- @ = 1.20
- # = 1.50
- = 1.70
- ▲ = 2.00
- s = sharp
- f = full

SECTION AREA:	325.41	mm ²
EST.WEIGHT PER MTR:	0.879	kg
EXT CIRCUMFERENCE:	200.00	mm
INT CIRCUMFERENCE:	31.86	mm
mat'l. 6063 T6 TO BS EN 755-9		

DO NOT SCALE FROM THIS PAPER DRAWING

Quote Ref: Q11603/2022

Location Checked

Date

Signature

CRITICAL DIMENSIONS
MUST BE CHECKED

- 1
- 2
- 3
- 4
- 5
- 6
- 7
- 8
- 9
- 10

PLEASE ADVISE OF ANY AREAS WITH CRITICAL DIMENSIONS ABOVE.

Painted Aluminum

Scale 1:1

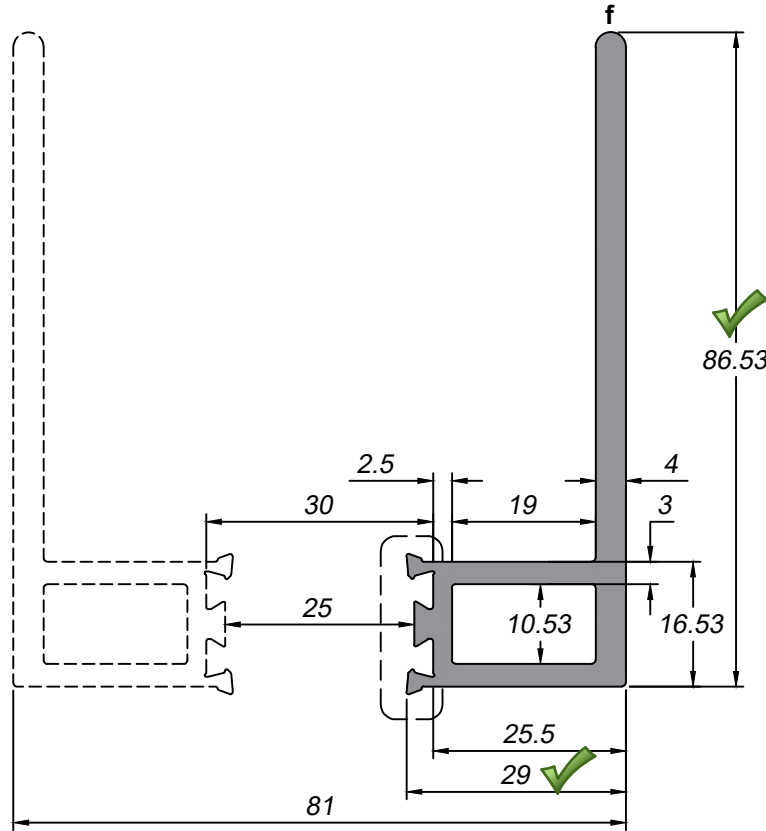

Scale 1:2

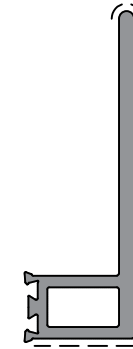

Scale 3:1

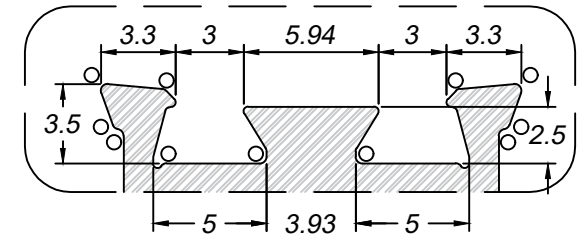

No unauthorised use, copy or disclosure of this drawing is to be made. It is to be returned whenever required.

Rev. No.	Revision	Date
R1		



Report #: S2754-301-44
Date: 11/20/25
Verified by: [Signature]

intertek
Total Quality Assured.

PLEASE NOTE THAT IF THIS PROFILE IS REQUIRED IN ANODIZED QUALITY FOR A DECORATIVE FINISH AT A LATER DATE THAT BEFORE MANUFACTURE OUR QUALITY CONTROL AND PRODUCTION DEPARTMENTS WILL HAVE TO BE MADE AWARE AND TO AGREE TO PRODUCE ANY ORDERS.

Finish:		SECTION AREA:		526.20	mm²		
CLIENT Service Metals (East Anglia) Ltd	Customer Approved Signed :	V = 0.00mm x 90° Vee Groove Unspec. Radii to R0.20mm Unspec. Thickness: 0.00mm	EST.WEIGHT PER MTR:			1.421	kg
	Print Name:		EXT CIRCUMFERENCE:			247.45	mm
TITLE D11603A	Date :	Visible Surface - VS - - - - -	INT CIRCUMFERENCE:			58.20	mm
	 Smart Aluminium Extrusions, Arnolds Way, Yatton, North Somerset, BS49 4QN Tel: +44 (0)1934 876 100 Fax: +44 (0)1934 835 169 www.smartsystems.co.uk		mat'l. 6063 T6 TO BS EN 755-9				
			DRAWN DML DATE MARCH 2022 SCALE 1:1 SCALE @ A4	DRAWING No. SWL7998		DIE No. SM	

- RADII**
- = 0.20
 - ∅ = 0.25
 - = 0.30
 - x = 0.40
 - = 0.50
 - * = 0.75
 - △ = 1.00
 - @ = 1.20
 - # = 1.50
 - = 1.70
 - ▲ = 2.00
 - s = sharp
 - f = full

No unauthorised use, copy or disclosure of this drawing is to be made. It is to be returned whenever required.

Rev. No.	Revision	Date
(R1)		

←R1

Quote Ref: Q16195A/2024

Location Checked

Date

Signature

CRITICAL DIMENSIONS MUST BE CHECKED

- 1
- 2
- 3
- 4
- 5
- 6
- 7
- 8
- 9
- 10

Scale 2:1

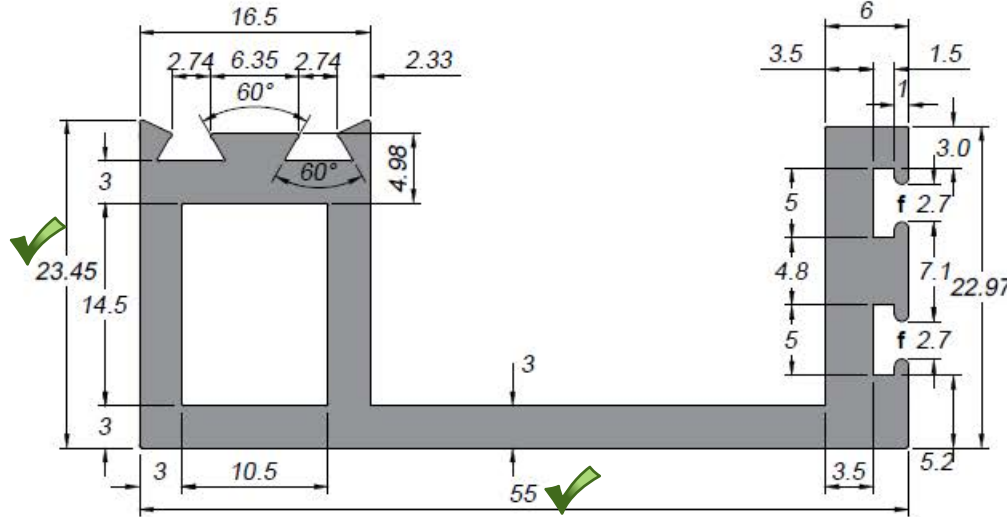

Scale 1:1

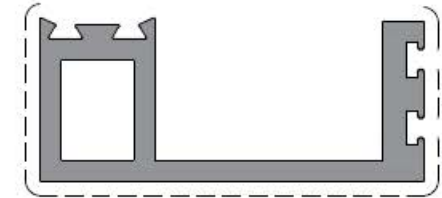

Customer BS EN 755 - 9 Tolerance Acceptance. All Extrusion tolerances will be to this standard unless agreed otherwise with our production department before running any bulk material. Critical dimensions should be advised and listed above.

Signed :
.....
Print Name:
.....
Date :
.....

intertek
Total Quality. Assured.

Report #: S2754-301-44
Date: 11/20/25
Verified by: *[Signature]*

Painted Aluminum

PLEASE NOTE THAT IF THIS PROFILE IS REQUIRED IN ANODIZED QUALITY FOR A DECORATIVE FINISH AT A LATER DATE THAT BEFORE MANUFACTURE OUR QUALITY CONTROL AND PRODUCTION DEPARTMENTS WILL HAVE TO BE MADE AWARE AND TO AGREE TO PRODUCE ANY ORDERS.

Finish: Painted

SECTION AREA: 420.50 mm²

CLIENT
Sherwood Stainless & Aluminium Ltd

Customer Approved
Signed :
Print Name:
Date :

V = 0.00mm x 90° Vee Groove
Unspec. Radii to R0.25mm
Unspec. Thickness: 3.00mm

RADII
● = 0.20
○ = 0.25
○ = 0.30
x = 0.40
□ = 0.50
* = 0.75
△ = 1.00
@ = 1.20
= 1.50
▲ = 1.70
■ = 2.00
s = sharp
f = full

EST.WEIGHT PER MTR: 1.140 kg

EXTERNAL PERIMETER: 227.39 mm

INTERNAL PERIMETER: 49.66 mm

TITLE
Top Track Extrusion

Smart Aluminium Extrusions,
Anricks Way, Yatton,
North Somerset,
BS40 4GN
Tel: +44 (0)1934 876 100
Fax: +44 (0)1934 835 189
www.smartsystems.co.uk

DRAWN MCA
DATE SEP 2024
SCALE VARIOUS SCALES @ A4

mat'l. 6063 T6 TO BS EN 755-9

DRAWING No. SWL9285 DIE No. SM****

DO NOT SCALE FROM THIS PAPER DRAWING

Quote Ref: Q16195BMOD/2024	Location Checked	Date	Signature
----------------------------	------------------	------	-----------

No unauthorised use, copy or disclosure of this drawing is to be made. It is to be returned whenever required.

Rev. No.	Revision	Date
(R1)		

CRITICAL DIMENSIONS MUST BE CHECKED

1
2
3
4
5
6
7
8
9
10

Scale 2:1

intertek
Total Quality. Assured.

Report #: S2754-301-44
Date: 11/20/25
Verified by: *[Signature]*

Scale 1:1

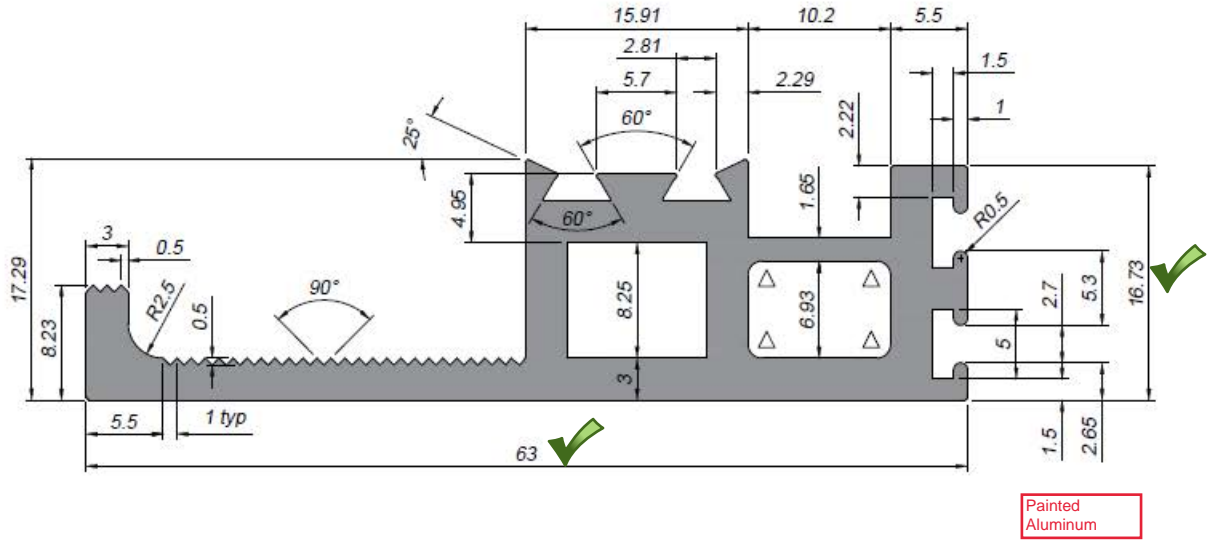
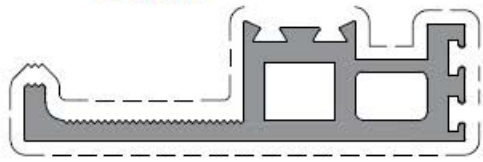

Customer BS EN 755 - 9 Tolerance Acceptance. All Extrusion tolerances will be to this standard unless agreed otherwise with our production department before running any bulk material. Critical dimensions should be advised and listed above.

Signed :
.....
Print Name:
.....
Date :
.....

PLEASE NOTE THAT IF THIS PROFILE IS REQUIRED IN ANODIZED QUALITY FOR A DECORATIVE FINISH AT A LATER DATE THAT BEFORE MANUFACTURE OUR QUALITY CONTROL AND PRODUCTION DEPARTMENTS WILL HAVE TO BE MADE AWARE AND TO AGREE TO PRODUCE ANY ORDERS.

Finish: Painted		SECTION AREA:		386.00	mm²		
CLIENT Sherwood Stainless & Aluminium	Customer Approved Signed : Print Name : Date :	V = 0.00mm x 90° Vee Groove Unspec. Radii to R0.25mm Unspec. Thickness: 3.00mm	EST.WEIGHT PER MTR:			1.046	kg
			EXTERNAL PERIMETER:			221.61	mm
Visible Surface - VS - - - - -			INTERNAL PERIMETER:			69.03	mm
			mat'l. 6063 T6 TO BS EN 755-9				
TITLE Profile Track Extrusion	Smart Aluminium Extrusions, Arnolds Way, Yatton, North Somerset, BS40 4DN Tel: +44 (0)1934 876 100 Fax: +44 (0)1934 835 160 www.smartalloys.com.co.uk	RADII ● = 0.20 ⊘ = 0.25 ○ = 0.30 x = 0.40 □ = 0.50 * = 0.75 △ = 1.00 @ = 1.20 # = 1.50 ▲ = 1.70 s = sharp f = full	DRAWN MCA DATE SEP 2024 SCALE VARIOUS SCALES @ A4	DRAWING No. SWL9286	DIE No. SM****		

Quote Ref: Q16195CMOD/2024	Location Checked	Date	Signature

No unauthorised use, copy or disclosure of this drawing is to be made. It is to be returned whenever required.

Rev. No.	Revision	Date
(R1)		

CRITICAL DIMENSIONS MUST BE CHECKED

1
2
3
4
5
6
7
8
9
10

Scale 2:1

intertek
Total Quality. Assured.

Report #: S2754-301-44
Date: 11/20/25
Verified by: *[Signature]*



Scale 1:1

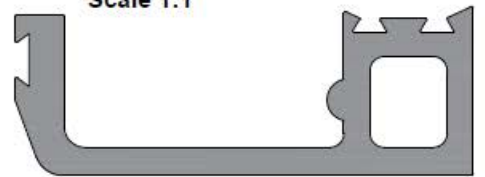

Customer BS EN 755 - 9 Tolerance Acceptance. All Extrusion tolerances will be to this standard unless agreed otherwise with our production department before running any bulk material. Critical dimensions should be advised and listed above.

Signed :
.....
Print Name:
.....
Date :
.....

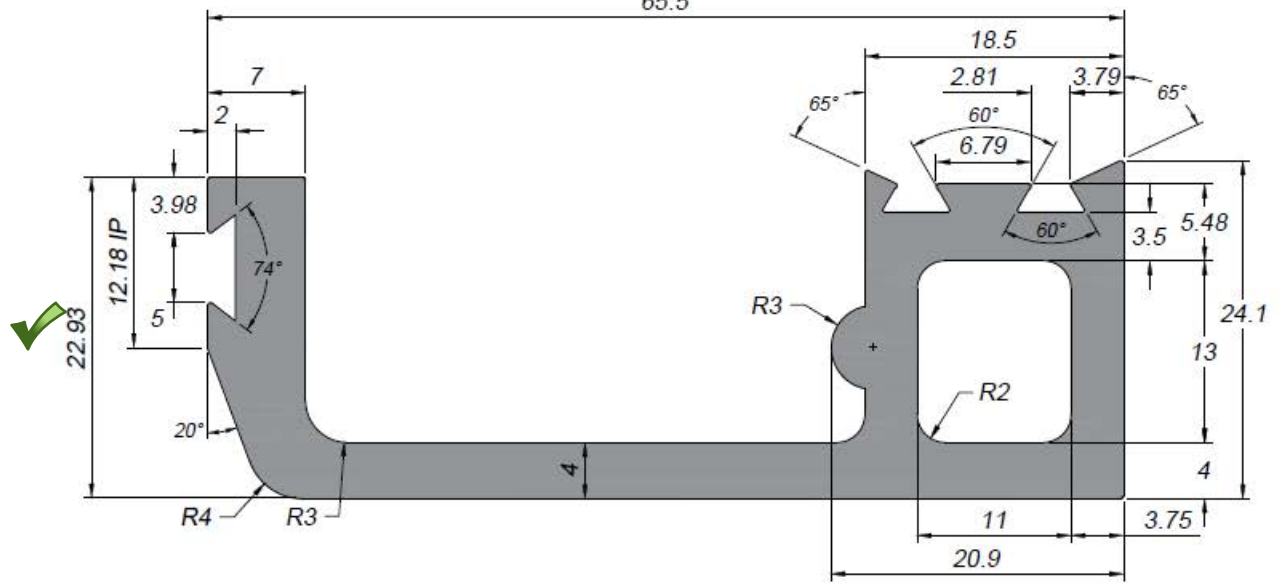

Painted Aluminum

PLEASE NOTE THAT IF THIS PROFILE IS REQUIRED IN ANODIZED QUALITY FOR A DECORATIVE FINISH AT A LATER DATE THAT BEFORE MANUFACTURE OUR QUALITY CONTROL AND PRODUCTION DEPARTMENTS WILL HAVE TO BE MADE AWARE AND TO AGREE TO PRODUCE ANY ORDERS.

Finish: Painted		SECTION AREA: 564.73 mm ²	
CLIENT	Customer Approved	EST.WEIGHT PER MTR: 1.530 kg	
Sherwood Stainless & Aluminium Ltd	Signed :	EXTERNAL PERIMETER: 233.02 mm	
	Print Name:	INTERNAL PERIMETER: 44.57 mm	
TITLE	Date :	mat'l. 6063 T6 TO BS EN 755-9	
	Bottom Track Extrusion	DRAWING No. SWL9287	
Smart Aluminium Extrusions, Arncliffe Way, Yatton, North Somerset, BS349 4JN. Tel: +44 (0) 1934 676 100 Fax: +44 (0) 1934 835 169 www.smartaluminium.co.uk		DIE No. SM****	
V = 0.00mm x 90° Vee Groove Unspec. Radii to R0.25mm Unspec. Thickness: 0mm		Visible Surface - VS	
DRAWN: MCA		RADII	
DATE: SEP_2024		● = 0.20	
SCALE: VARIOUS SCALES @ A4		⊘ = 0.25	
		○ = 0.30	
		x = 0.40	
		□ = 0.50	
		* = 0.75	
		△ = 1.00	
		@ = 1.20	
		# = 1.50	
		▲ = 1.70	
		s = sharp	
		f = full	

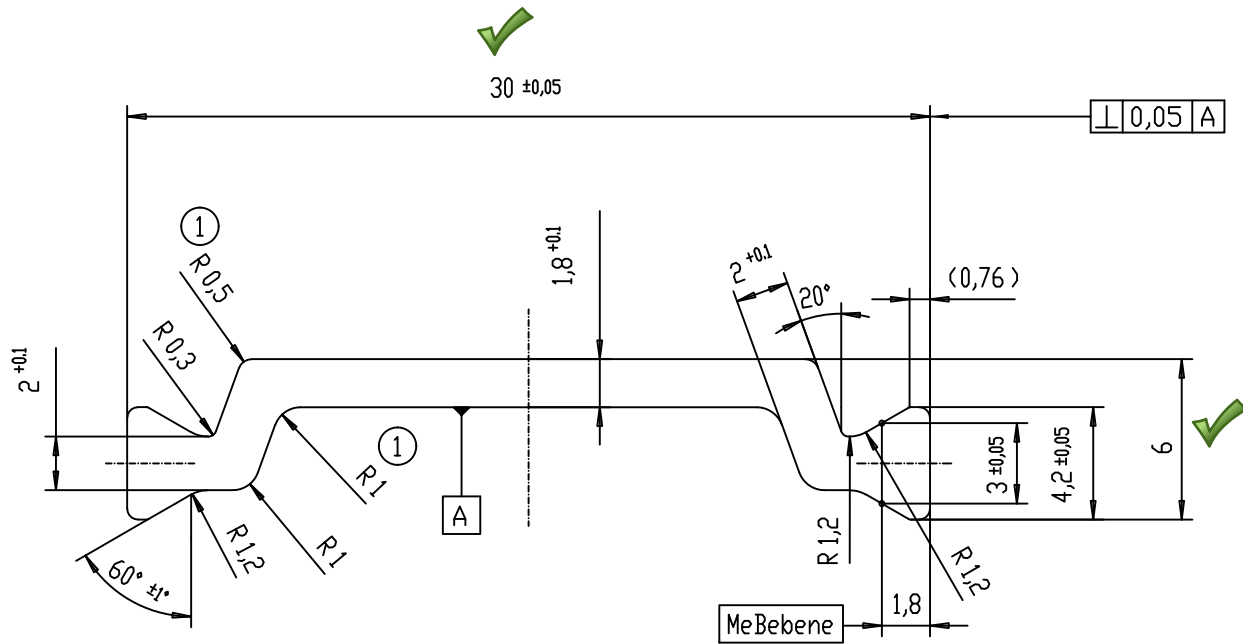

Report #: S2754-301-44
 Date: 11/20/25
 Verified by: *[Signature]*

intertek
 Total Quality. Assured.

unbemaßte Radien = R 0,2

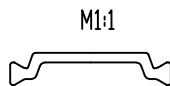

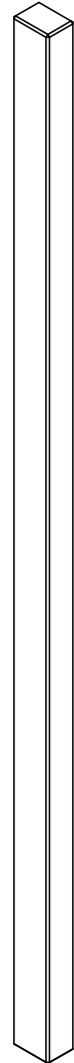
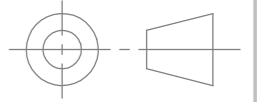

U = 77 mm A = 72 qmm		Auftraggeber		Zeichnungs-Nr. des Auftraggebers	
		Freimaßtoleranz DIN 16941 Reihe 2		Oberflächen DIN ISO 1302	
		Maßstab M 5:1 (1:1)		Gewicht	
		Werkstoff PA 66 GF25 trockenschlagzäh		Benennung	
		1996 Datum Name		Isoliersteg	
		Bearb. 10.10. HSch			
		Gepr.			
		Norm			
		Technoform BAUTEC Kunststoffprodukte GmbH		947400	
1 Radien geändert 23.05.05 HSch		34277 Fuldaabrik/Kassel		Blatt	
Zust.	Änderung	Datum	Name	Urspr.	Ers.f.
					Ers.d.

RESEARCH & DEVELOPMENT : P5 PROJECT

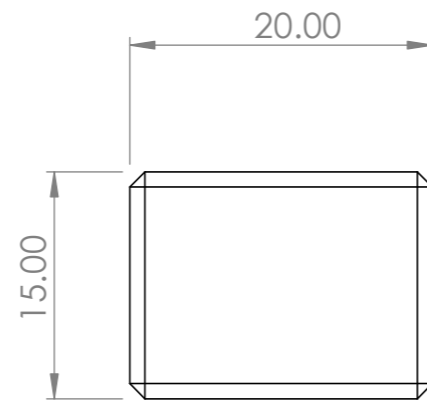

**LENGTH OF SPACER IS DETERMINED
BY STRUCTURAL OPENING SIZE**



	Report #:	S2754-301-44
	Date:	11/20/25
	Verified by:	

 <p>FRAMELESS GLASS CURTAINS (FGC) OWN THE COPYRIGHT OF THIS DRAWING WHICH IS SUPPLIED IN CONFIDENCE ON THE EXPRESS CONDITION THAT IT IS NOT USED, REPRODUCED OR COMMUNICATED TO ANY OTHER PERSON WITHOUT THE PERMISSION IN WRITING FROM THE OWNER</p>					CLIENT:	Frameless Glass Curtains			TITLE:	INSTRUMENT GLASSES - GLASS SPACER BAR		
					DRAWN BY:	J.Cuffe	APPROVED BY:	P.Beresford	DATE:	16/08/2023		
					UNLESS OTHERWISE SPECIFIED: DIMENSIONS ARE IN MILLIMETERS TOLERANCES: ± 0.15 ANGLE: $\pm 0.5^\circ$ SURFACE FINISH: NO WORSE THAN 0.8 μm			DEBURR AND BREAK SHARP EDGES	FINISH:	TOUGHENED		
						DO NOT SCALE DRAWING	MATERIAL: PLANIBEL (FLOAT GLASS)			DWG NO:	IG-GSB-01	A3
	1	16/08/2023	JC	PB						SCALE:1:5	SHEET 1 OF 1	
ISS	DATE	DRN	APP	CRN								



Total Quality. Assured.

2524 E. Jensen Ave
Fresno, California 93706

Telephone: 559-233-8705
Facsimile: 717-764-4129
www.intertek.com/building

TEST REPORT FOR FRAMELESS GLASS CURTAINS LIMITED

Report No.: S2754.03-301-44-R0

Date: 03/04/26

SECTION 14

REVISION LOG

REVISION #	DATE	PAGES	REVISION
0	03/04/26	N/A	Original Report Issue